



BILGIN YACHTS

**EACH CREATION RETAINS THE DISTINCTIVE
SIGNATURE OF BILGIN'S RICH HERITAGE**



BILGIN YACHTS

BILGIN 156 ON SPEC (UNDER CONSTRUCTION)



L.O.A : 47.60 m

Beam : 8.80 m

Draft : 2.60 m

Launching Date : 2017

Type : Displacement Motor yacht

Speed max. : 16 knots



BILGIN 156

BILGIN YACHTS





BILGIN YACHTS

Not simply a business...

Each one of our creations retains the distinctive signature of Bilgin Yacht's rich heritage while pushing the boundaries. Just like the BILGIN 156, thanks to the cooperative work between the Bilgin team and Unique Yacht Design, we believe to be redefining the word we call 'ambitious'... The project is now well advanced and we are very excited to see the end product. This is the defining legacy of the Şengün family: the past is the reservoir from which we have drawn inspiration; the future is the dreams we will transform into reality. For us, shipbuilding is not simply a business. It is a calling passed down from generation to generation."

İsmail Şengün - CEO, Bilgin Yachts Shipyard





BILGIN YACHTS

BILGIN 156 (on spec)

The vessel will not exceed the 500GT mark, and is designed with clean exterior lines, portraying a classic and timeless appearance. With exterior styling and naval architecture by Unique Yacht Design, H2 created the general arrangement and interior design concept. The layout adopts a four larger-cabin layout instead of five cabins, with a generous owners suite which also benefits from a hull balcony. The result is spacious accommodation for 10 guests in a highly modern bright interior featuring large windows. Subtle touches such as a combination of wood variants and precious metals are introduced in this minimalist copper coloured scheme.





BILGIN YACHTS

BILGIN 156 Main Characteristics

1- General - This specification describes a distinguished twin screw motor, displacement yacht which is intended to be used for coastal and offshore unrestricted cruising around Europe, Mediterranean, Atlantic and Caribbean's.

2- Design:

- Interior Design : H2 Yacht Design
- Exterior Design : Unique Yacht Design
- System Design : Unique & Bilgin Yacht Design Team
- Naval Architect. : Unique Yacht Design

3- Main Particulars: The yacht has the following main particulars:

● Length Overall	47.60 m	(156')
● Length Waterline	41.40 m	(135' 7")
● Beam Overall	9.20 m	(30' 2")
● Draught	2.60 m	(8' 6")
● Displacement	470 tons	(Full Load)
● Gross Tonnage	495 GRT	
● Performance	16 knots	(full speed)
● Fuel Tank	67300 liters	(17800 US gallons)
● Fresh Water Tank	12300 liters	(3250 US gallons)
● Grey Water Tank	5700 liters	(1500 US gallons)
● Black Water Tank	2400 liters	(650 US gallons)
● Lube Oil Tank	1000 liters	(265 US gallons)
● Dirty lube Oil Tank	1200 liters	(320 US gallons)

4- Regulations: The yacht is built and equipped complying with the RINA C Maltese Cross, Hull, Mach; Y unrestricted and LY3 regulations.

5- Construction: Steel hull & Aluminum Superstructure in accordance with rules and regulations of recognized classification society and flag state.



BILGIN YACHTS

6- Machinery, Propulsion & Equipment: The following equipment's are fitted:

- Main Engines : 2x MTU 12V 2000 M72 1448bhp 2250 rpm Marine Diesel Engine
- Generators : 3x 80kW Kohler ADV 8507 Marine Diesel Generator
- Propellers : 5 blade propellers 1400mm diameters
- Shafts : 120mm diameter, duplex S.S. water lubricated shafts
- Bow Thruster : Sidepower SAC610-1100 Electric Bow Thruster
- Stabilizer : TRAC 540 26X Fin Stabilizer
- Steering System : Hidromarin Hydraulics
- Pumps : Azcue pumps
- Fixed Fire System : Ultra-Fog System
- Freshwater Maker : Tecnicomar, SAILOR S3-40, 8400lt/day
- Boiler : 2x 250 liters by DIKO
- Sewage Treatment Unit : Tecnicomar, Ecomar 16
- Sanitary System : Jets Vacuum System
- Anchor Windlass : Hidromarin Hydraulics
- Mooring Capstans : Hidromarin Hydraulics
- Sliding Doors : Custom made by Brillmar
- Watertight Hatches : Custom made by Brillmar
- Galley Equipment : Siemens
- Cold Room : Custom made
- Sound System : Harman Kardon voice and sound system by Savant Automation
- Underwater Lights : Cantalupi
- Air Conditioning : 480.000 BTU capacity chiller system
- Fans & Fire Dampers : Gianneschi
- Pasarella : Sanguinetti or equivalent
- Cranes : Custom made by Brillmar



BILGIN YACHTS

Accommodation: The following cabins and compartments are located at four decks of the yacht:

- 4 Guest Cabins
- 1 Master Cabins
- 1 Captain Cabin
- 4 Crew Cabins
- 2 Saloons
- Sundeck Area
- Beach Club & Garage Area (both used as tender storage and living area)
- 3 Shell Doors (Side shell door for tender launching, transom door for Beach club and balcony at master cabin)
- 2 Jacuzzis

7- Navigation Equipment: Navigation equipment will be fitted in accordance with regulations A3 unrestricted navigation.





BILGIN 156 MAIN DECK SALOON / LOUNGE

BILGIN YACHTS



Bilgin 156 m Main Sloop Lounge



Bilgin 156 m Main Sloop Cabinetry Detail



Bilgin 156 m Main Sloop Cabinetry Detail

Any material hand or body touches is natural. The most distinguishing characteristic of her interior design is that, 3 completely different natural material trying to carry out the same style and texture. Marble, copper and leather are perpetual with each other's characteristics where ever they are applied.

Leather, reflecting the copper... The copper material which determines the general lines of the design with the horizontal stripes at the common spaces stick with the design line with leather used in the cabins. The warm colour tones used in copper and leather are balanced with the cold color tones of the marble. 'Transparent' copper and glass materials which were used with modern lines create a perception where it feels like looking behind a tulle. The materials that we have been familiar for centuries such as leather, natural stones and copper are displaying a pretty modern outlook with the way they were applied in the interior design.

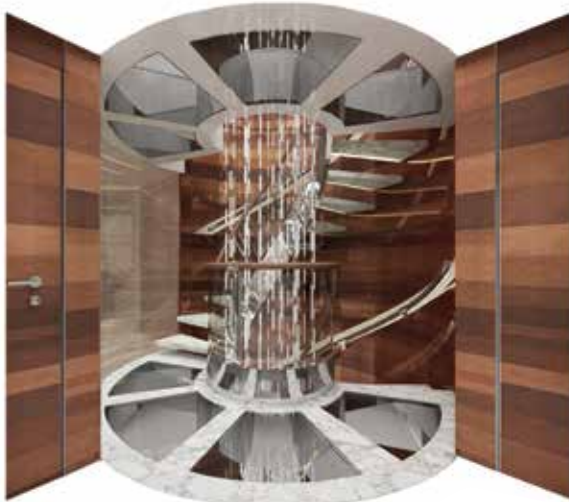

Bilgin 156 m Main Deck Staircase

The space where the stairs were located is just in the middle of the yacht in the general arrangement plans. This enables all areas from upper deck to guest cabins get the daylight.



BILGIN 156 MAIN MAIN DECK DINING / LOBBY

BILGIN YACHTS



Bilgin 156 m Lobby Detail



Bilgin 156 m Main Sloop Dining Area



Bilgin 156 m Lobby



Bilgin 156 m Main Sloop Dining Area



Bilgin 156 m Lobby Detail



BILGIN YACHTS



Bilgin 156 m Main Sloop Dining Area

“Copper is one of the hardest natural materials to use on marine products. So processing and applying this material requires a high level technology and a masterful manual labor. Another very gentle material, eucalyptus tree, is used for veneers. These are the challenges of working on BILGIN 156, and we, as Bilgin team, are very happy to be challenged.”

Bilgin Design Team

“Subtle touches such as a combination of wood variants and precious metals are introduced in this minimalistic copper coloured scheme. Applied together with red brown and white colour tones, copper creates a ‘monochrome’ effect. And this effect displays the most compelling example of the contrasts.”

Tam Elder - Project Manager, H2 Yacht Design



BILGIN YACHTS

BILGIN 156 MAIN MAIN DECK OWNERS SUITE



Bilgin 156 m Lobby



Bilgin 156 m Lobby



Bilgin 156 m Lobby



Bilgin 156 m Lobby



Bilgin 156 m Owner Suite Office



Bilgin 156 m Owner Suite Bedroom

Moore & Giles, Edelman, Spinneybeck, Robert Spurway brands were used with leather products.



BILGIN YACHTS

BILGIN 156 MAIN MAIN DECK OWNERS SUITE/BATHROOM



Bilgin 156 m Owner Suite Bedroom & Office



Bilgin 156 m Owner Suite Bathroom



Bilgin 156 m Owner Suite Bathroom



Bilgin 156 m Owner Suite Bathroom



BILGIN YACHTS

BILGIN 156 EXTERIOR

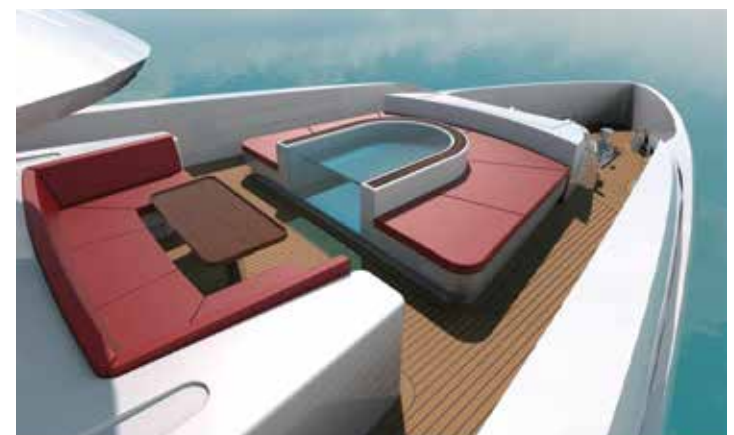
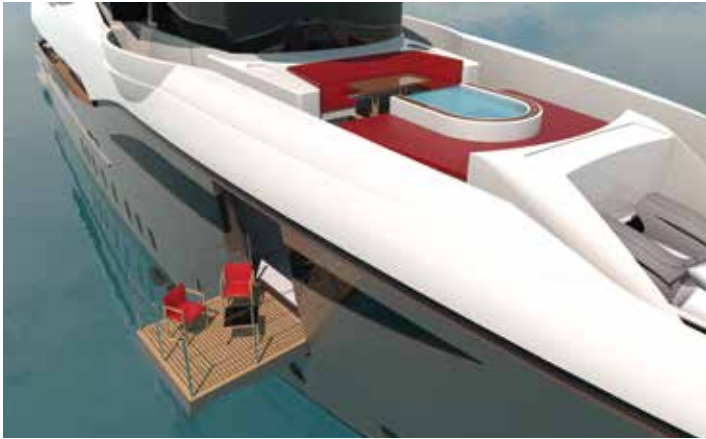



BILGIN YACHTS

Bilgin Team Message

"BILGIN 156 has the advantage to get registered for commercial use under 500 GT while being able to navigate under unrestricted service. She also gives the opportunity to her owner to satisfy minimum safe manning requirements with less crew. This provides lower operating costs."

Sencer Güneer - Project Manager, Bilgin Yachts Shipyard



Unique Message

"It is always exiting to see the end product for a designer. But with BILGIN 156 we can't wait to see the reactions of the people after the completion of her construction by globally known Turkish craftsmanship..." Emrecan Özgün - Founder & CEO, Unique Yacht Design



BILGIN YACHTS

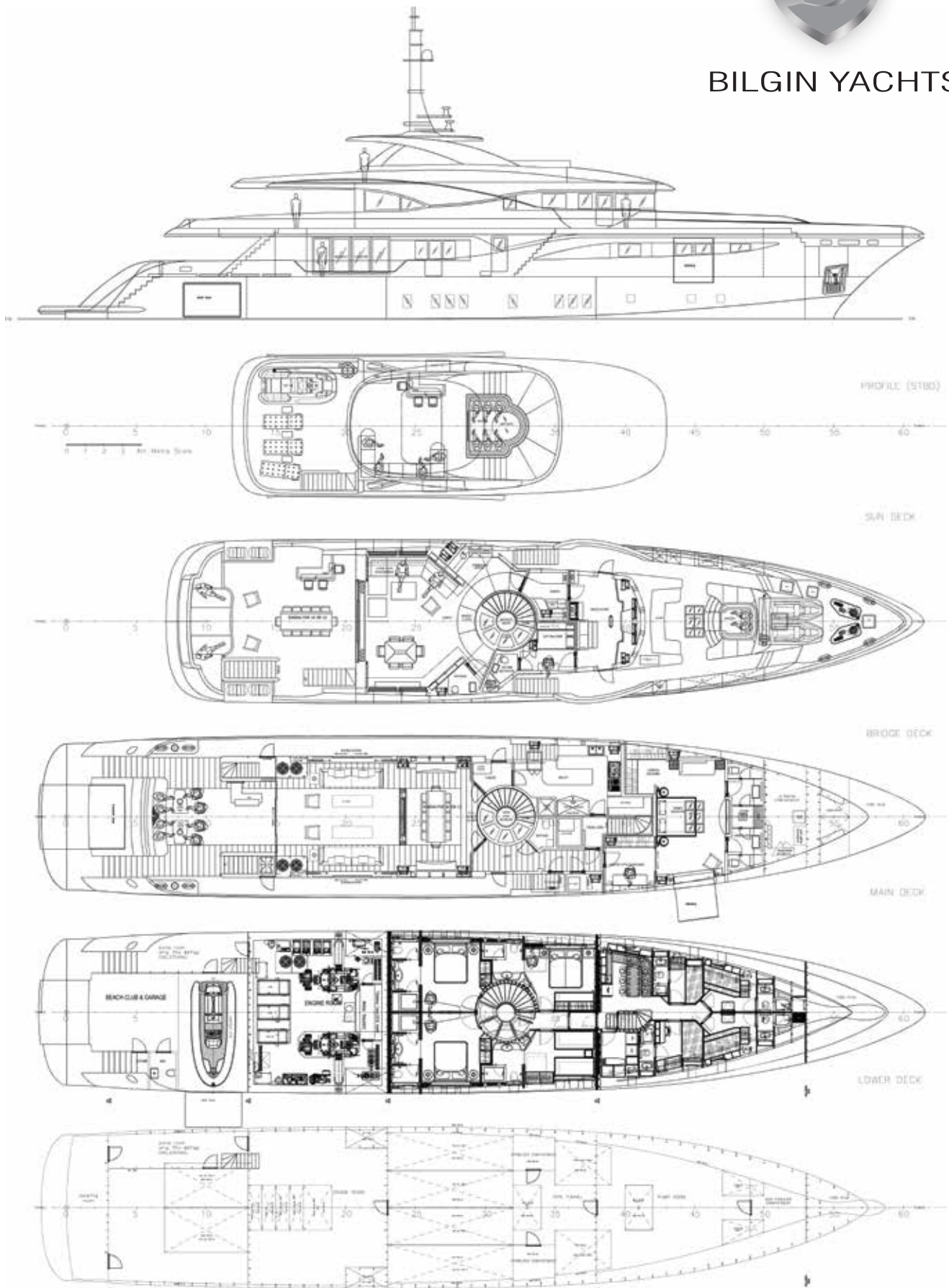



BILGIN YACHTS

İç Kumsal Mevkii
Bizim Sokak No:45 34290
Küçükçekmece / ISTANBUL / Turkey

Phone + 90 212 599 63 53
Gsm + 90 532 792 87 82
France + 33 768 63 63 85
Spain + 34 617 64 54 74
Fax + 90 212 599 62 43

e-mail info@bilginyacht.com,
sales@bilginyacht.com
mns@bilginyacht.com

www.**bilginyacht**.com