

SUNREEF 70

Specification 2009/2010



General Specification

Length overall:	21,40 m	70'
Waterline length:	20,40 m	67.3'
Breadth overall:	10,40 m	34'
Lightship displacement (without additional options):	31 T	69 440 lbs
Draft maximum (without additional options):	1,60 m	5.2'
Mast length:	27 m	88,6'
Fully battened main sail:	145 m ²	1 561 ft ²
Spinnaker (option):	300 m ²	3 229 ft ²
Gennaker (option):	150 m ²	1 614 ft ²
Genoa:	95 m ²	1 023 ft ²
Solent (option):	50 m ²	538 ft ²
Storm jib (option):	7 m ²	75 ft ²
Main engines (upgradable):	2 x 160 HP	2 x 160 HP
Fuel capacity (upgradable):	2 x 900 L	2 x 238 Gal
Water capacity:	2 x 750 L	2 x 200 Gal
Number of people (category A):	16	

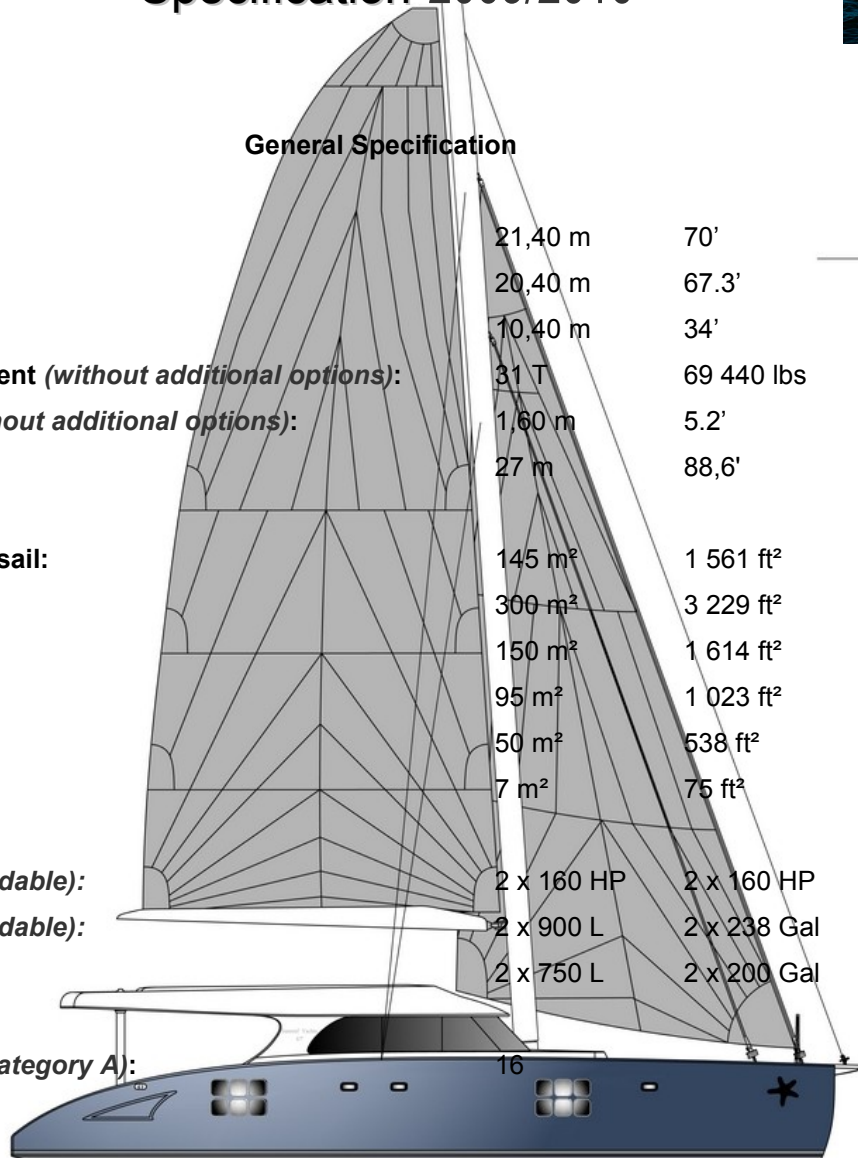

Construction

Standard:

- Hulls, deck, flybridge and all structural bulkheads constructed of glass/vynilester sandwich laminate with carbon reinforcement by infusion process
- Rudders constructed of a moulded sandwich glass/vynilester. Rudder stocks are in aluminium alloy
- Extended reenforced longitudinal beam
- Catwalk fitted on the forward beam
- Aft platform

SUNREEF 70

Specification 2009/2010



Rigging & Sails

Standard:

- Carbon mast with incorporated LEDs (27 m)
- Carbon boom
- Plastic protections on the shrouds
- Lazy jack
- Fully battened main sail made of Dacron 1st choice, cross cut, 2 reefs
- Genoa double pleated made of Dacron 1st choice
- Mast steps up to boom

Options:

- Fully battened main sail tri-radial cut (*with options of different materials*)
- Storm jib made of Dacron 1st choice, cross cut
- Solent (*with options of different cuts and materials ; requires complete gear*)
- Genoa tri-radial cut (*with options of different materials*)
- Gennaker Polyester stormlite (*requires complete gear*)
- Spinnaker (*requires complete gear*)
- Complete gear for solent
- Complete gear for Gennaker
- Complete gear for Spinnaker
- Electric furling system for Solent and/or Genoa
- Electric furling system for Gennaker

Mechanics

Standard:

- 2 complete engines 160 HP (Yanmar)
- Stainless steel shafts
- 2 three-bladed folding propellers
- 2 fuel tanks of 900 L each
- 2 Engine speed controls (*one at the navigation table and one on the flybridge*)
- 1 electric pump + 1 manual for fuel tanks
- Lights in the engine rooms

SUNREEF 70

Specification 2009/2010



Mechanics

Options:

- Upgrade to 2 complete engines 240 HP (Yanmar) with a pair of four-bladed feathering propellers
- Consumption estimation system
- Extra engine speed controller in the cockpit
- 2 electric bow thrusters
- 2 electric oil changing pumps located in the engine rooms
- Extension of the fuel tanks to 2 x 3000 L
- 2 extra engine instruments at the navigation table
- Fuel polishing system

Deck Gear

Standard:

- Bow pulpits with integrated teak seats
- Gangway
- Lewmar port lights
- Swim ladder on the skirts
- Winches
- Blocks and jammers
- Genoa manual furler
- Deck light
- Electric lifting system for the dinghy with extendable arms and remote controller

Options:

- Main sail electric winch
- 2 primary electric winches
- All electric winches
- Bimini on the flybridge (*stainless steel*)
- Rigid wave breaking window on flybridge (*requires bimini*)
- Bimini windshield (*requires bimini*)
- Carbon foldable gangway 350 cm

SUNREEF 70

Specification 2009/2010



- Hydraulic gangway
- Hydraulic swim ladder
- Gas barbecue in stainless steel
- Rotating deck search-light
- 2 additional lights for the flybridge with separate switch
- 2 fresh water outlets at the bottom of the mast and in the cockpit
- 4 extra waterproof speakers in the cockpit and on the flybridge
- LEDs in skirts' stairs, cockpit and flybridge
- 2 aft capstans for mooring

Steering system

Standard:

- Rudders constructed of a moulded sandwich lamination glass/ vynilester
- Self-aligning lower and top bearings
- 5 strokes steering wheel (*diameter 1000 mm*)
- Hydraulic steering system
- 2 emergency tillers

Options:

- 3 strokes carbon steering wheel (*diameter 1200 mm*)

Electrical systems

Standard:

- AC-230V: Main switchboard, Charger (75A) / inverter (2500W) 24V, Shore power inlet (32 A inlet), Shore power cord (1 x 20m 3-cond), Wiring (*special marine quality*)
- DC-24V: Main switchboard, 8 house batteries (12V/900Ah), 2 starting batteries (12V/160Ah), DC distribution, Wiring (*special marine quality*)

Options:

- Additional upgrade of electrical kit:
 - AC -230V: Main panel extension, 2 chargers (24V/100A), Inverter(24V/5000W), Additional 220 V socket in cabins, saloon and galley

SUNREEF 70

Specification 2009/2010



- DC -24V: Main panel extension, Battery monitor BTM, 12 house gel batteries (24V/1200Ah), 2 starting batteries (12V/200Ah), Ivo compact 12V/25A
- 110V shore connection kit: Voltage selector 110/230 VAC (*with soft start*), Isolation transformer 10 KVA, Selector switch 50/60 Hz
 - Frequency inverter 60Hz/50Hz 18
 - KVA
 - 2 alternators 24V/110A
 - Generator 19 or 27 KVA, 220 Volts

Lighting

Standard:

- Lighting with halogen lamps

Options:

- Lights on dimmer
- Domotic system for lighting control (*programmable switches with digital display*)
- Optical fibres lights in the cockpit (*effect of "ciel étoilé"*)
- Underwater lights (*Halogen or Xenon*)

Navigation & electronics

Standard:

- Compass (*size 135mm*)
- Chronometer and barometer
- Radiotelephone

Options:

- Electronic pack 1: Speed, depth and wind display
- Electronic pack 2: (*includes pack 1*) Autopilot with gyrocompass, 2 pilot control heads, Rudder angle repetitor
- Electronic pack 3: (*E-Series ; includes pack 1 & 2*) GPS, Radar 4kW, 2 multifunction displays E80, ST 60 display
- Electronic pack 4 (*G-Series*) : ST70 multifunction display with speed, depth and wind display, Autopilot with gyrocompass, 2 pilot control heads, Rudder angle repetitor, GPS, Digital radar, 2 multifunction displays G120, Separate processor module, Wireless keyboard controller in the saloon

SUNREEF 70

Specification 2009/2010



- Connection between navigation instruments and PC
- Fishfinder (*optionally G-Series*)
- Display E120 instead of E80 (*E-Series*)
- Display duplicate on the saloon TV
- ST 60 or ST 70 (*G-Series*) multifunction display in cabin
- Smart Controller (*wireless autopilot controller with instrument repeater*)
- Yacht Controller (*remote controller for engines, windlass and bow thrusters – optionally*)
- Joystick steering controller at the navigation table
- External camera with colour and night vision
- Upgraded external thermal camera with colour and night vision and man overboard search
- Satellite communication Fleet 77: Voice 4.8 speech / 64 Kbps high quality, Data 56/64 Kbps ISDN, MPDS, Fax 14.4 Kbps 3.1 KHz audio channel, 64 Kbps group 4 fax channels, 9.6 Kbps group 3 fax channels
- Satellite broad band 250 or 500

Plumbing

Standard:

- Fresh water : 2 x 750 L equipped with level indicators, 2 pressurized pumps with stainless steel tank , 2 water heaters of 80 L each
- Black water : 2 x 137 L each tanks with gravity discharge system, 2 electric pumps with automatic discharge equipped with 3 way valves (*discharge in the sea or holding tanks*)
- 4 electrical bilge pumps
- 2 manual bilge pumps
- 2 hand showers on deck

Options:

- Watermaker 60 or 220 L/h – 24V
- 2 x 170 L grey water tanks with electric pumps of additional extraction and piping installation
- Sea water pump for washing the deck
- Electric toilets 24V in bathrooms with fresh water flush (*silence version*)
- Waste water treatment system

SUNREEF 70

Specification 2009/2010



Comfort on board

Standard:

- Curtains on all cabin portlights and saloon windows
- Gas oven
- 4-burner stove
- Separate refrigerator 355 L and freezer 249 L in galley

Options:

- **Generalities:**
 - All manually recessed Skyscreen blinds
 - Electrically recessed Skyscreen blinds in the saloon (*manual in the cabins*)
 - All electrically recessed Skyscreen blinds
 - Manually concealed Skyscreen with anti-mosquito screens on cabin ceiling hatches
 - Stainless steel sliding door instead of aluminium (*upgrade*)
 - Electrical stainless steel sliding door instead of aluminum one
 - Fitted forepeak with bed
 - Fitted forepeak with bed, toilet, shower and sink
- **Electrical appliances:**
 - Air conditioning installation in the saloon, galley and cabins : 72000 or 120000 BTU
 - Heating system (*requires air conditioning installation*)
 - Ventilator set in each cabin, in the galley and deck
 - Washing machine / dryer with complete installation
 - Dishwasher with complete installation
 - Stainless steel microwave with optional oven and grill function
 - Electric oven instead of gas
 - Trash compactor
 - Cooker hood
 - Ice maker
 - Wine cooler for 32 bottles

SUNREEF 70

Specification 2009/2010



• Leisure items:

- Widescreen LCD TV in the saloon (32" or 40")
- Hi-Fi Pack 1, 2 & 3 (*home-theater system in the saloon: Harman/Kardon, Bose or Bang&Olufsen*)
- LCD TV 20" + DVD/CD player in cabin
- TV antenna and satellite TV antenna
- Safe
- Electric diving compressor 6 m³/hour and 6 diving bottles holder
- Full-size back cushions on the seat behind cockpit table
- Full-size back cushions on the flybridge
- Jet ski
- Jet ski crane and locker
- Jacuzzi on the flybridge

Finishing

Standard:

- Furniture and all interior panels made of individually selected wood of category A with mat polyurethane varnish
- All upholstery and cushions made of synthetic fabric
- Hull, deck, cockpit and flybridge in white or coloured gelcoat

Options:

- Design fee (*additional design modifications for selection of wider range of superior finishing materials*)
- Wood finished with gloss polyurethane lacquer instead of mat polyurethane lacquer (*needs design fee*)
- Wood finished with mat polyester lacquer instead of mat polyurethane lacquer (*needs design fee*)
- Wood finished with gloss polyester lacquer instead of mat polyurethane lacquer (*needs design fee*)
- Upgrade of wood from category A to category B (*needs design fee*)
- Upgrade of wood from category A to category C (*needs design fee and wood finished with polyester lacquer*)
- Interior upholstery and cushions in skai or leather instead of synthetic (*needs design fee*)
- Box for the Hi-Fi equipment with additional shelves (*needs Hi-Fi Pack*)

SUNREEF 70

Specification 2009/2010



- Side of hulls painted in colored gelcoat or high gloss colors
- Flybridge, deck and cockpit painted with high gloss
- Cockpit, flybridge and skirts covered with teak
- Deck covered with teak and installed flush hatches
- Front saloon windows finished with black hatch frames and dark plexi panel

Launching (*options only*)

- Antifouling (*with Epoxy primer*)
- Launching and setting of the mast
- Name and hailing port inscriptions
- Polish export fees
- Sunreef representative on board for 3 days till Kiel Channel – qualified engineer / sailor, 1 person
(*including crew training, first oil and filter change, and return costs*)
- Sunreef representative on board for 10, 20 or 30 days – qualified engineer / sailor, 1 person

Safety equipment

Standard:

- Automatic fire extinguishing system in the engine rooms

Options:

- Complete safety equipment pack : 2 life rafts for 8 people, Rescue equipment (*16 lifejackets, first aid kit, flares, lifebuoy, signaling mirror, wooden plugs, flag set, fog horn*), Set of fire extinguishers
- Adaptation to the MCA regulations for category 2
- Gas detection system + alarm (*included in MCA adaptation*)
- EPIRB (*included in MCA adaptation*)
- Man overboard system (*included in MCA adaptation*)
- Additional lifetags for man overboard system (*requires man overboard system*)
- Satellite tracking system with optional movement detection and anti-intrusion alarm (*excluding fees*)

Mooring & tools

Standard:

- Windlass 3000 W 24V
- Anchor 60 kg FOB + 80m galvanised chain (*diameter 13mm*)

SUNREEF 70

Specification 2009/2010



- Additional anchor 20kg + 20m galvanised chain (*diameter 10mm*)

Mooring & tools

Options:

- Additional windlass kit (*windlass 3000W/24V + anchor + galvanised chain + davit*)
- Mooring kit (*8 fenders + 4x20 m mooring ropes*)
- 50 m tow line (*diameter 20 mm*)
- Anchor 66 kg CQR instead of 60kg FOB
- Toolbox
- Shroud cutter

Spare parts (*options only*)

- Basic set of spare parts for engines and generator
- Additional set of spare parts for engines, generator, and fuel and water systems

SUNREEF 70

Specification 2009/2010



Accommodation

Luxury charter version 8 pax:



Charter version 12 pax:

SUNREEF 70

Specification 2009/2010

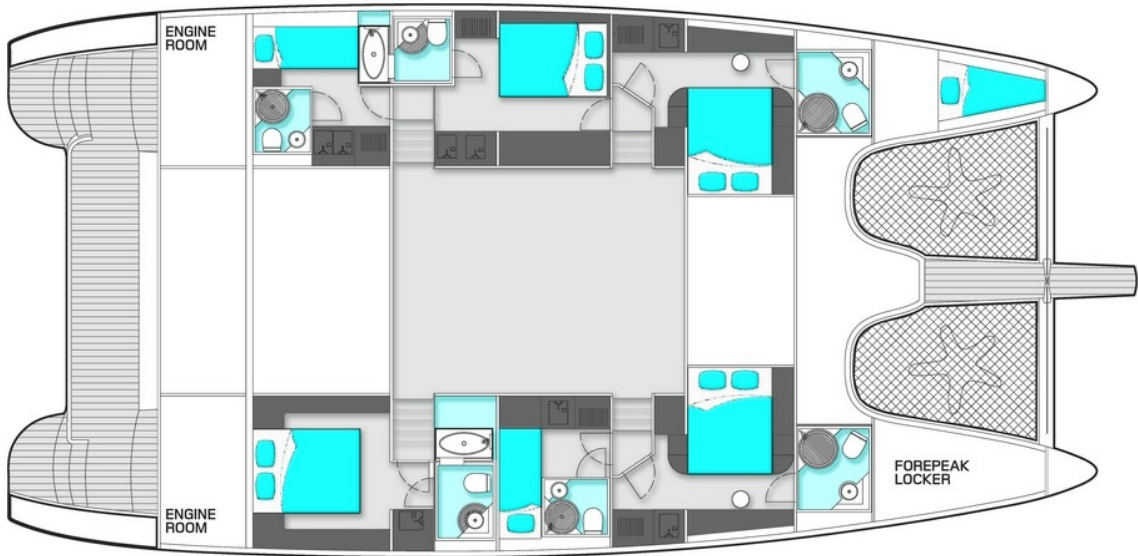

Accommodation

Charter version 14 pax:

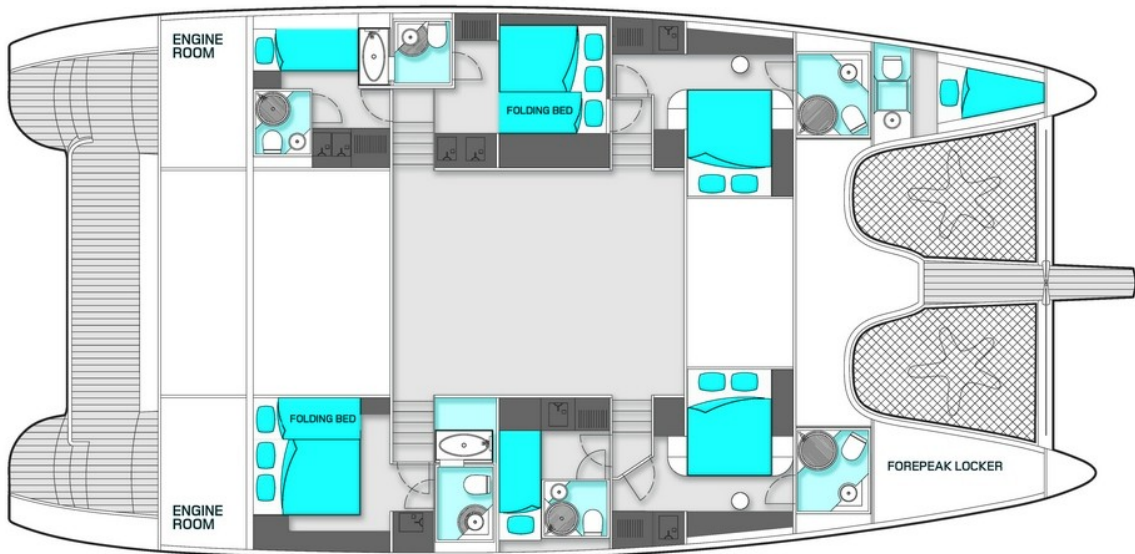

SUNREEF 70

Specification 2009/2010



Owner version (3 double cabins) :

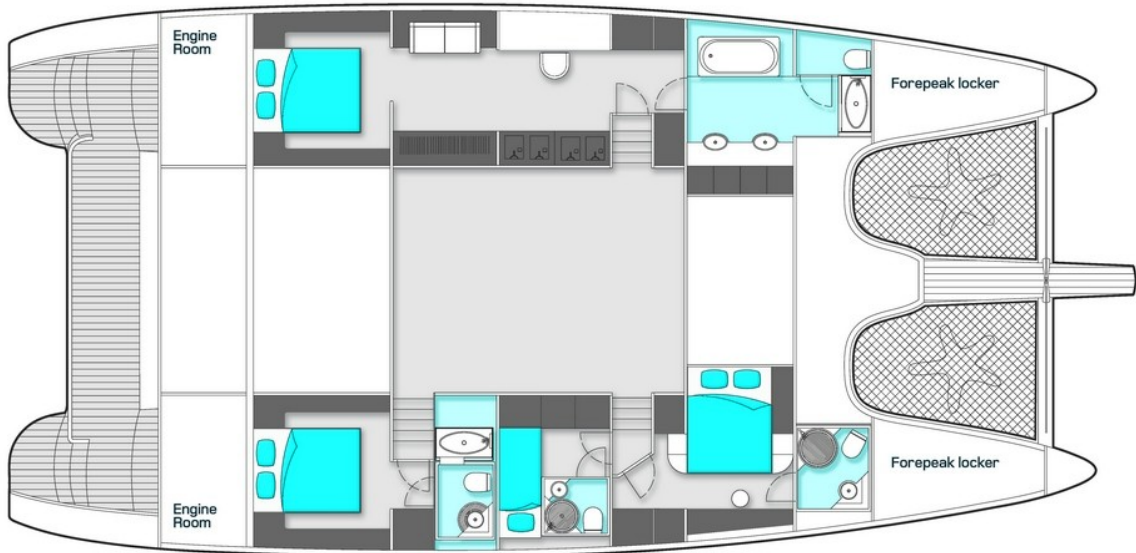

Accommodation

Owner version with galley down (3 double cabins) :

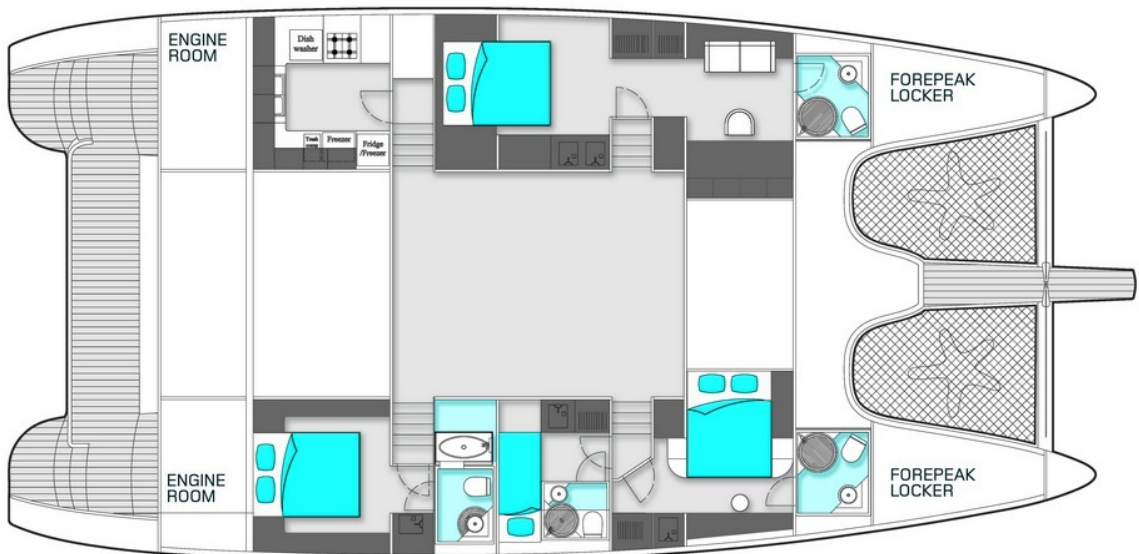

SUNREEF 70

Specification 2009/2010



Owner version with galley up (4 double cabins) :

