



































OUTBOARD PROFILE

PRINCIPAL CHARACTERISTICS

LENGTH HULL 24.680 m 81'0"
 LENGTH WATERLINE 21.640 m 70'9"
 BEAM 5.960 m 19'7"
 DRAFT 2.280 m 7'6"
 KEEL UP 4.100 m 13'6"
 KEEL DOWN
 DISPLACEMENT 49,500 kg 48.7 TON

ENGINE
 FUEL
 WATER
 SPEED
 RANGE

VOLVO D4 260 HP @ 3500 RPM
 2000 L 440 GALS
 1000 L 220 GALS
 11 KNOTS
 1000 NM @ 10 KNOTS

GENERATORS 1 x 25 KW MASTERVOLT
 AIRCONDITIONING 84 000 BTU
 WATERMAKER 1 x 1400 GPD
 BOWTHRUSTER 34 HP MAX POWER
 STERNTHRUSTER 34 HP MAX POWER



WARWICK 82 LK PERFORMANCE SLOOP

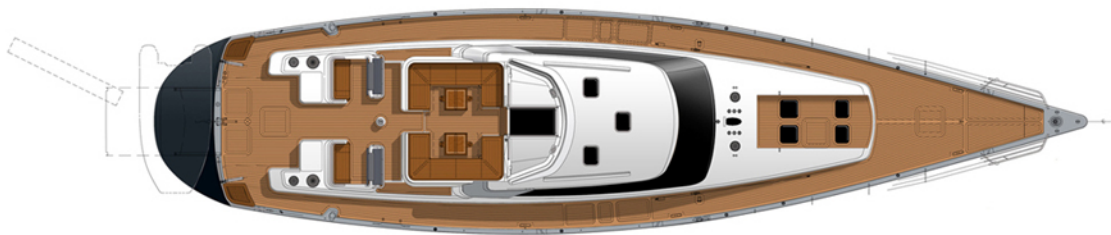

WARWICK 82 LK PERFORMANCE SLOOP

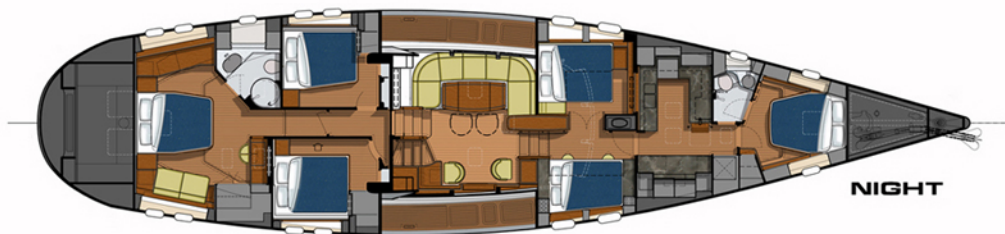

NIGHT

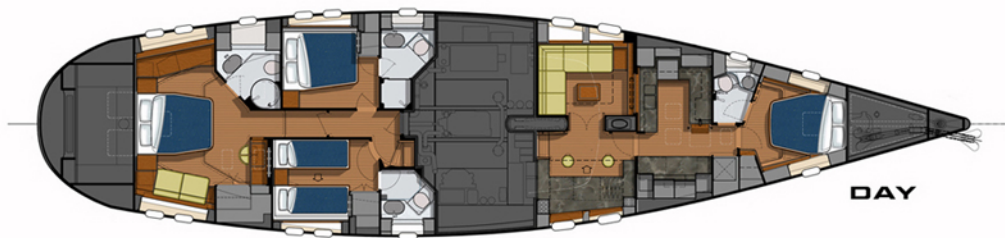

DAY



WARWICK 82 LK PERFORMANCE SLOOP

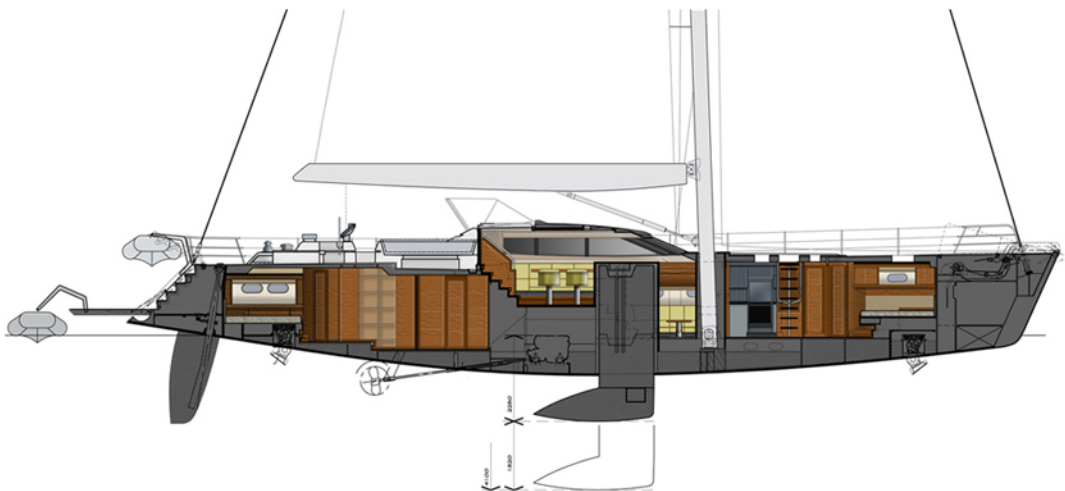

WARWICK 82 LK PERFORMANCE SLOOP

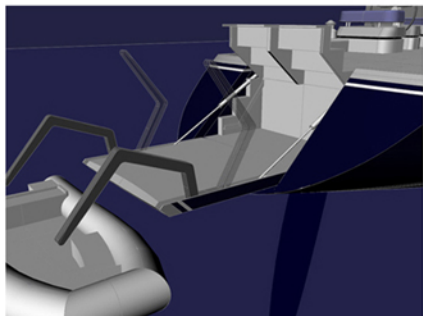
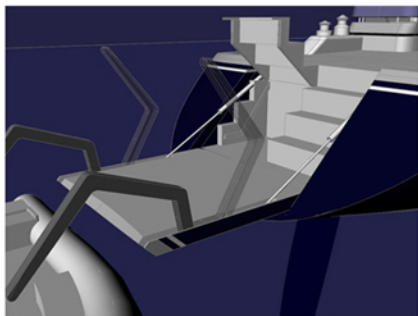
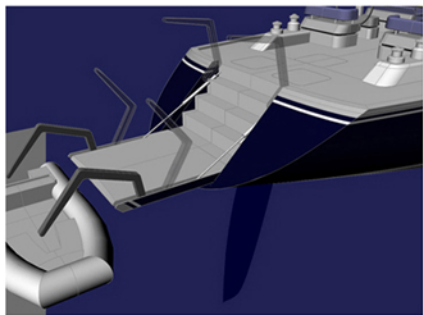
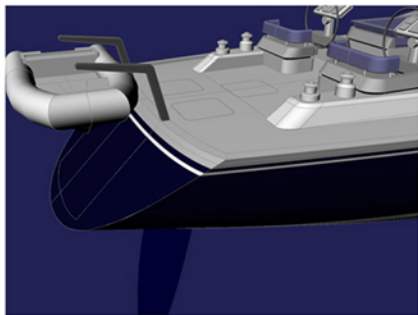

WARWICK 82 LK PERFORMANCE SLOOP